

Part No. B-35316-5 12 Inch Bolt.
Used with Part No. HD-39302.

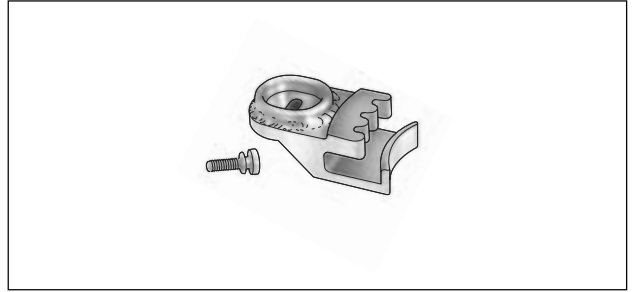

Part No. B-43982 Sprocket Locking Tool

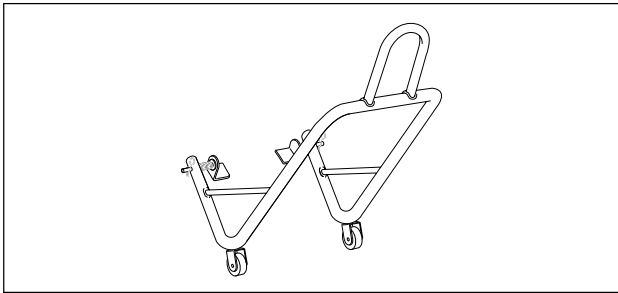

**Part No. B-41174 Rear Wheel Support Stand and
Part No. B-41174-2 Replacement Pad.**



Part No. B-43983 Main Drive Gear Cross Plate.
Used with Part No. HD-35316A.

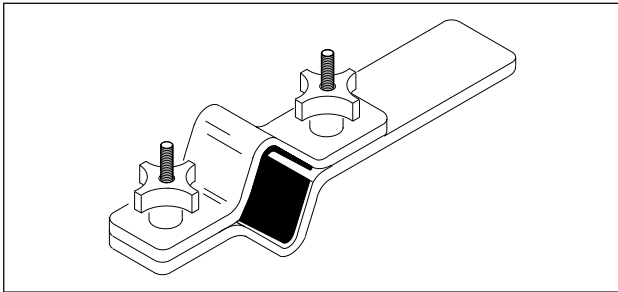

Part No. B-41177 Front Fork Holding Tool

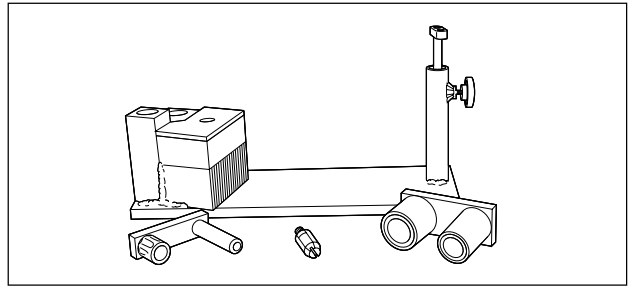

Part No. B-43985 Transmission Remover/Installer

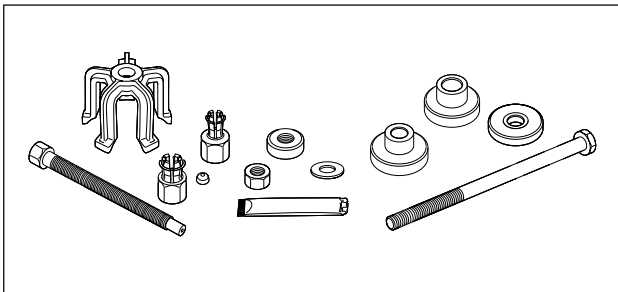

Part No. B-43933 Wheel Bearing Remover/Installer.
Use with Part No. HD-44060.

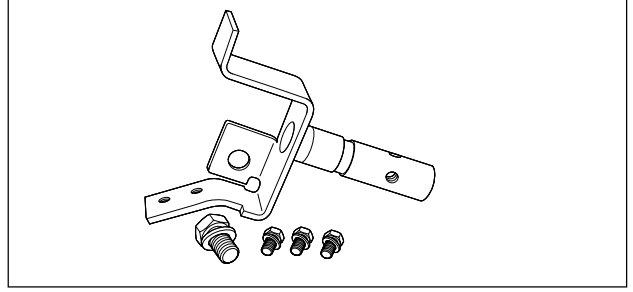

Part No. B-43987 Engine Cradle
Used with HD-42310

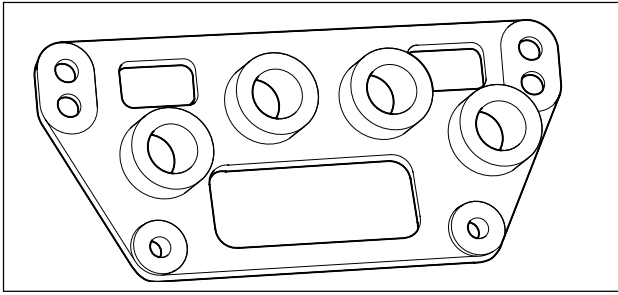

Part No. B-43988 Camshaft Bushing Reamer Fixture.
Use with Part No. HD-38871-2.

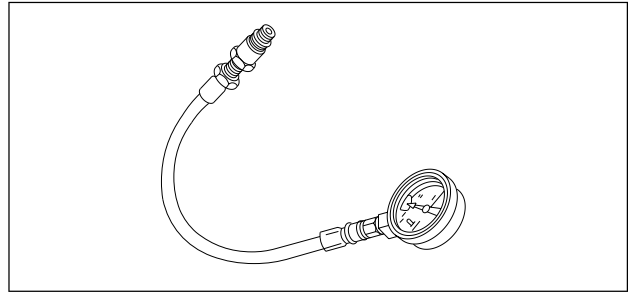

Part No. HD-33223-1 Cylinder Compression Gauge

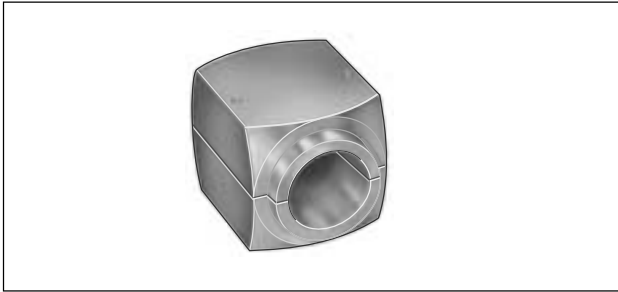

Part No. B-43991 Fork Seal/Bushing Driver

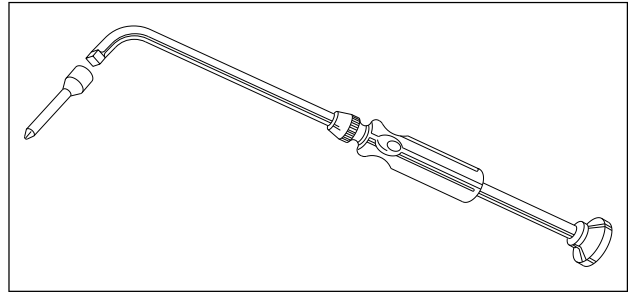

Part No. HD-33413-A Carburetor Idle Adjustment Tool

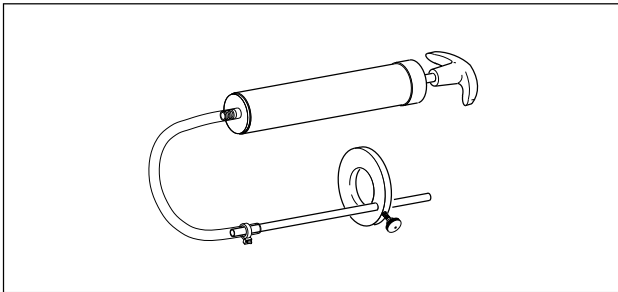

Part No. B-59000A Pro Level Oil Gauge

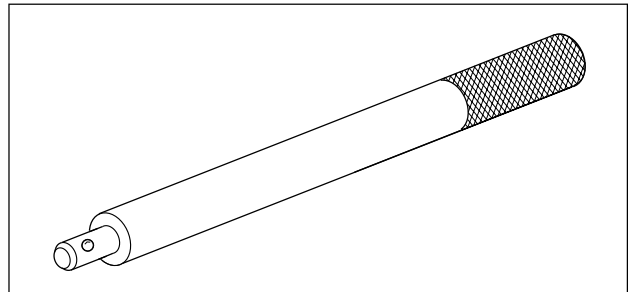

Part No. HD-33416 Universal Driver Handle

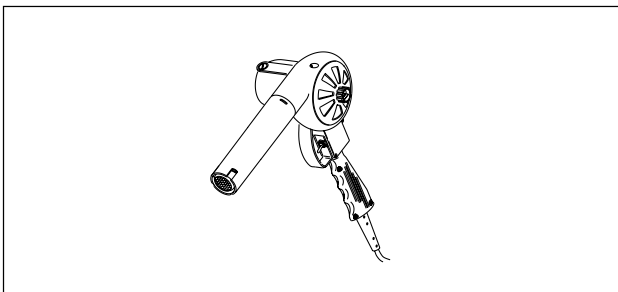

Part No. HD-25070 Robinair Heat Gun

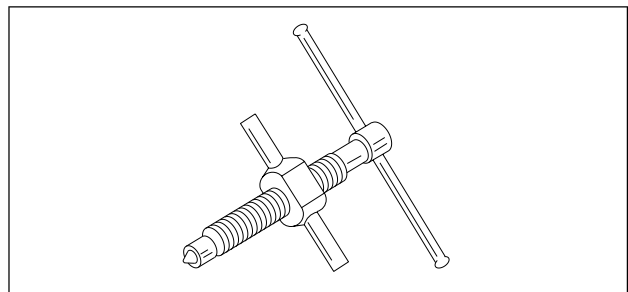

Part No. HD-33418 Universal Puller Forcing Screw

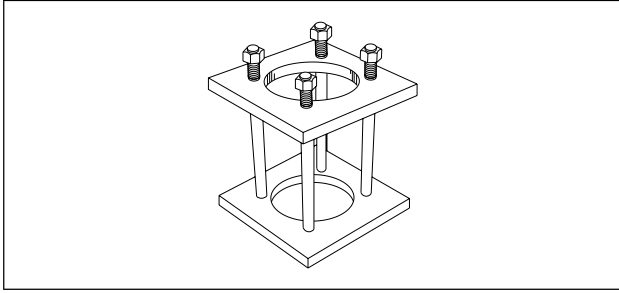

Part No. HD-33446A Cylinder Torque Plates and Torque Plate Bolts Part No. HD-33446-86.

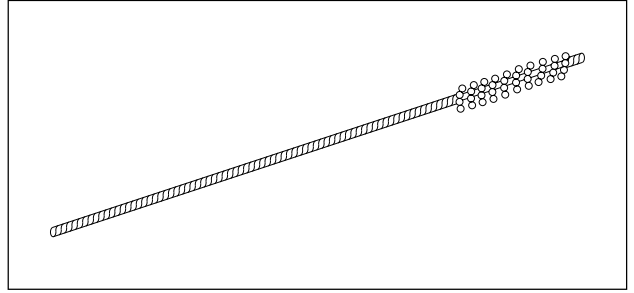

Part No. HD-34723 Valve Guide Hone (8 mm)

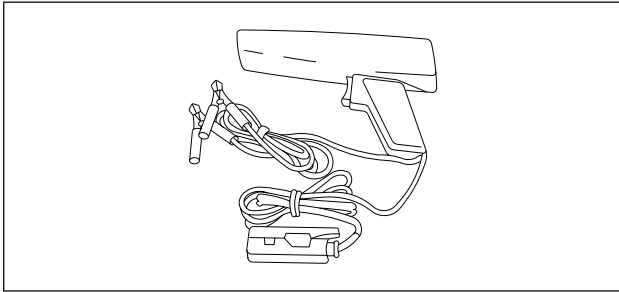

Part No. HD-33813 Inductive Timing Light

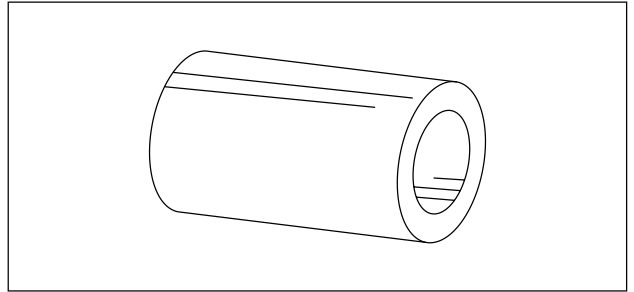

Part No. HD-34731 Shoulderless Valve Guide Installation Tool

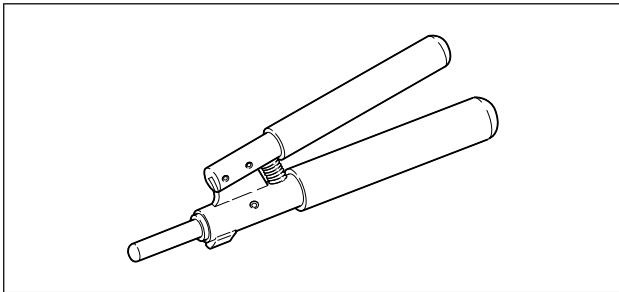

Part No. HD-34623B Piston Pin Retaining Ring Installer/Remover

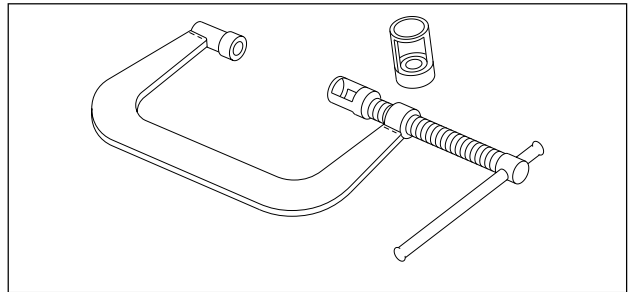

Part No. HD-34736B Valve Spring Compressor

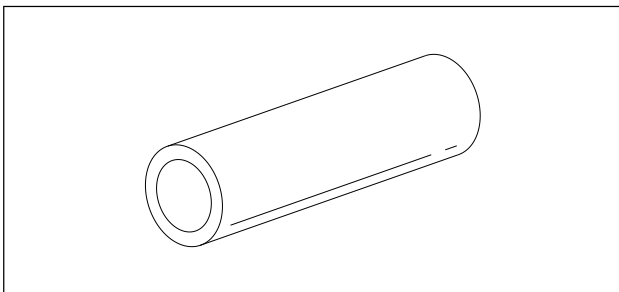

Part No. HD-34643A Shoulderless Valve Guide Seal Installer

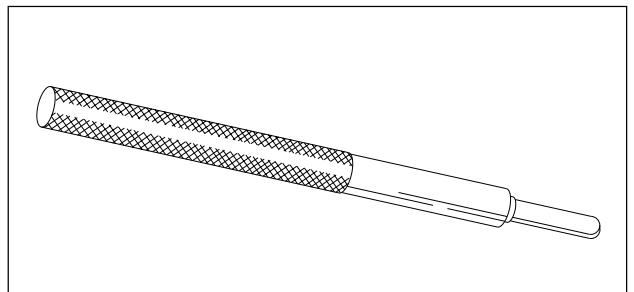

Part No. HD-34740 Driver Handle and Remover. Use with Part No. HD-34643A and art No. HD-34731.

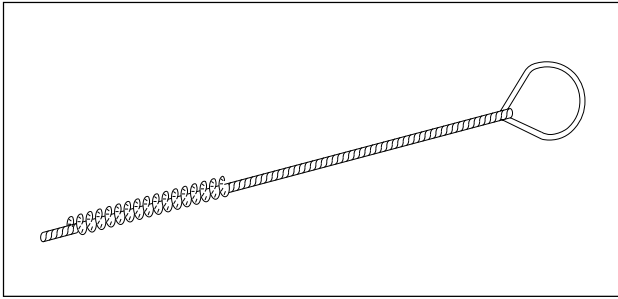

Part No. HD-34751 Nylon Valve Guide Brush

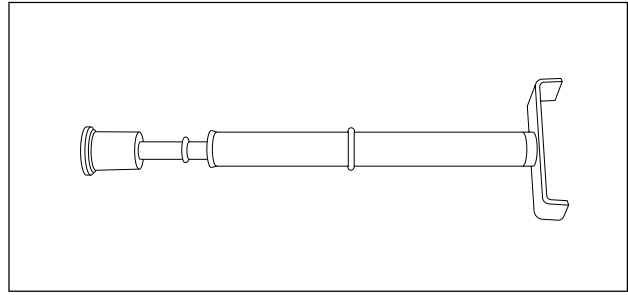

Part No. HD-35381 Belt Tension Gauge

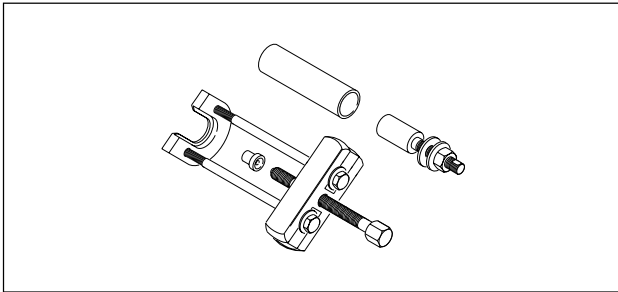

Part No. HD-34902-B Primary Bearing Race Remover/Installer

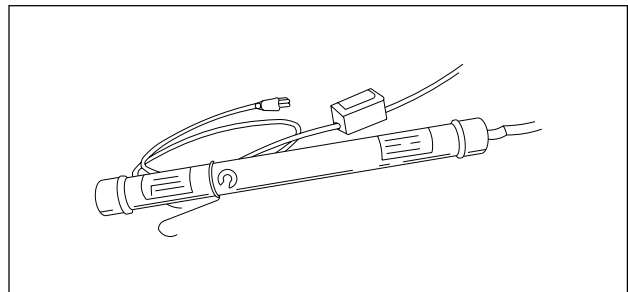

Part No. HD-35457 Black Light Leak Detector

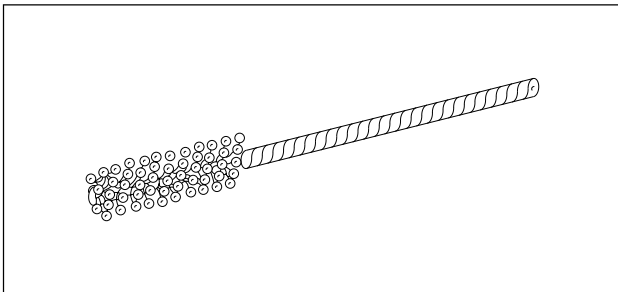

Part No. HD-35102 Wrist Pin Bushing Hone (20 mm)

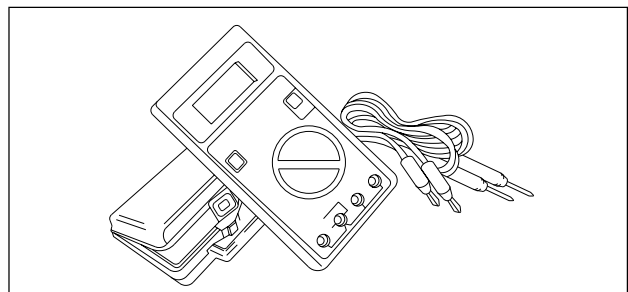

Part No. HD-35500A Digital Multi-Meter (FLUKE 23)

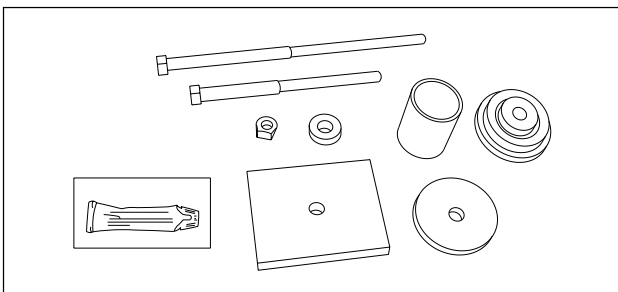

Part No. HD-35316-A Main Drive Gear Remover/Installer and Main Drive Gear Bearing Installer.

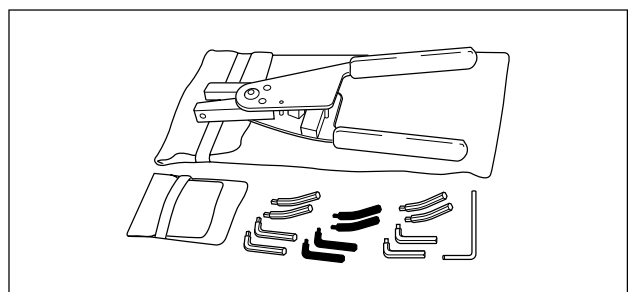

Part No. HD-35518 Internal/External Retaining Ring Pliers

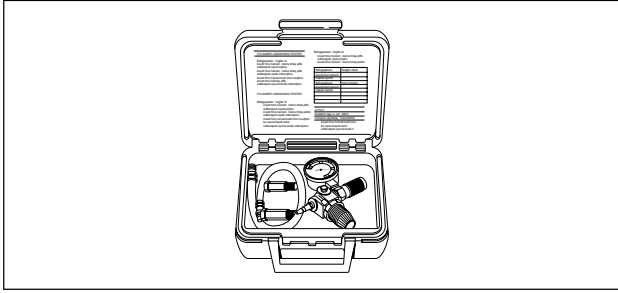

Part No. HD-35667A Cylinder Leakdown Tester

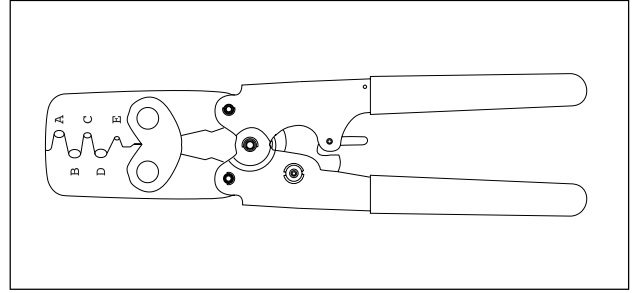

Part No. HD-38125-7 Packard Terminal Crimp Tool
(Sealed connectors)

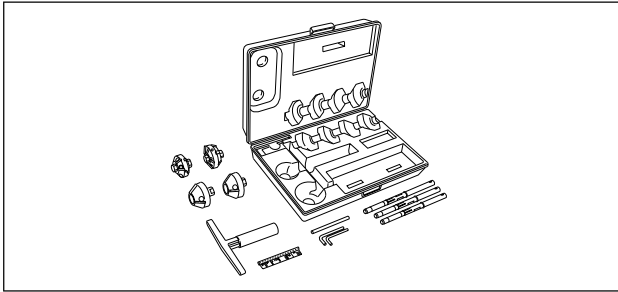

Part No. HD-35758 Neway Valve Seat Cutter Set

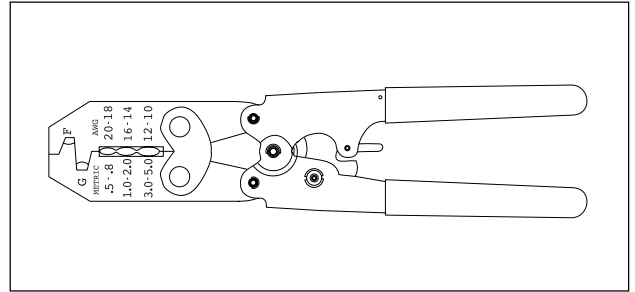

Part No. HD-38125-8 Packard Terminal Crimp Tool

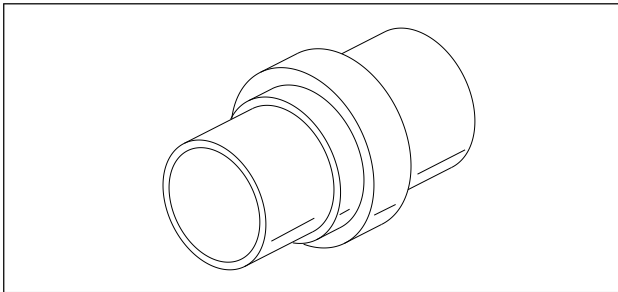

Part No. HD-37842A Inner/Outer Main Drive Gear
Needle Bearing Installer

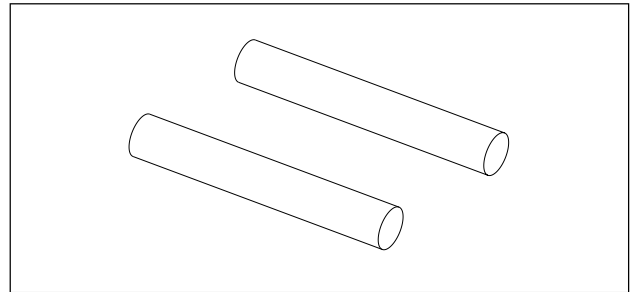

Part No. HD-38361 Cam Gear Gauge Pin Set
(0.108 in. (2.74 mm) Diameter)

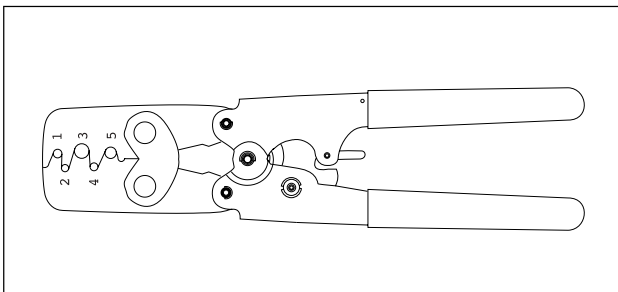

Part No. HD-38125-6 Packard Terminal Crimp Tool
(Sealed and non-sealed connectors)

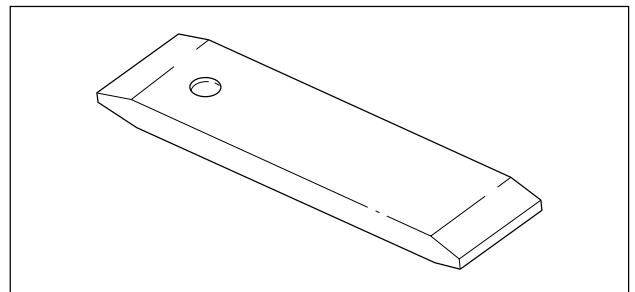

Part No. HD-38362 Sprocket Locking Link

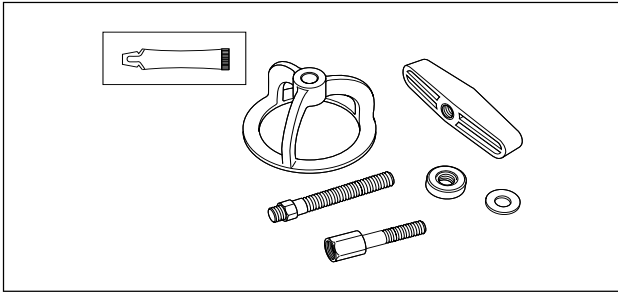

Part No. HD-38515-A Clutch Spring Compressing Tool and Part No. HD-38515-91 Forcing Screw.

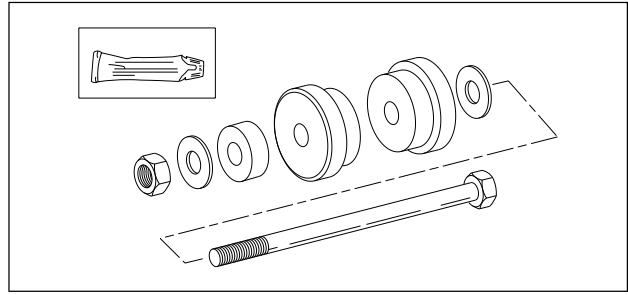

Part No. HD-39302 Steering Head Bearing Race Installer

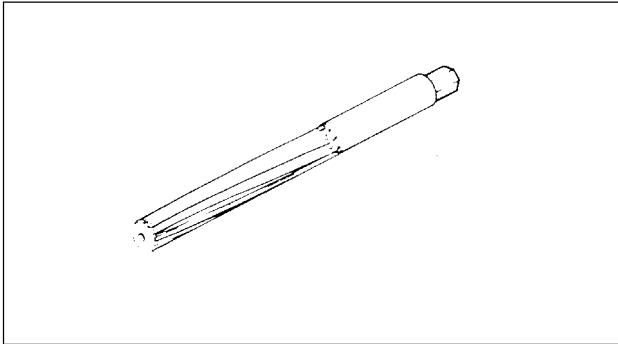

Part No. HD-38871- 2 Reamer. Use with Part No. B-43988 Camshaft Bushing Reamer Fixture

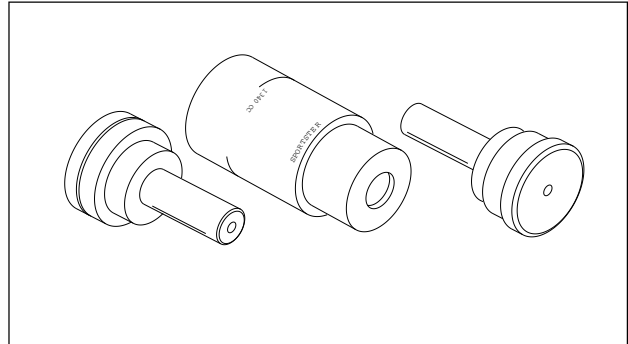

Part No. HD-39458 Sprocket Shaft Bearing Outer Race Installer

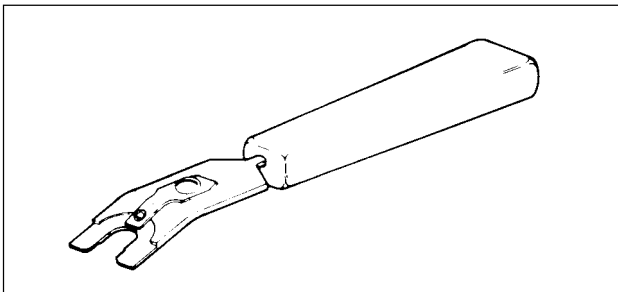

Part No. HD-39151 Shift Drum Retaining Ring Installer

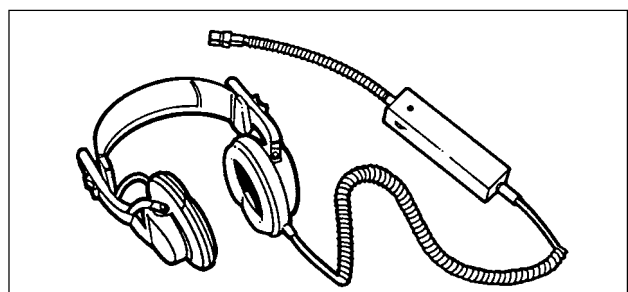

Part No. HD-39565 Engine Sound Probe

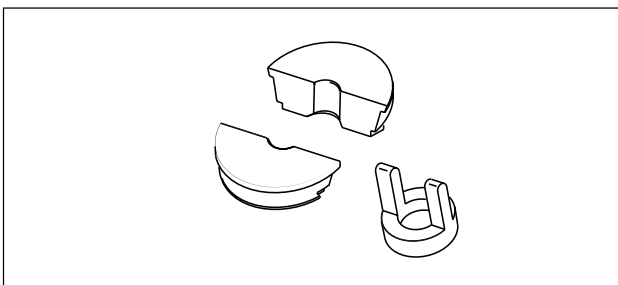

Part No. HD-39301-A Steering Head Bearing Race Remover

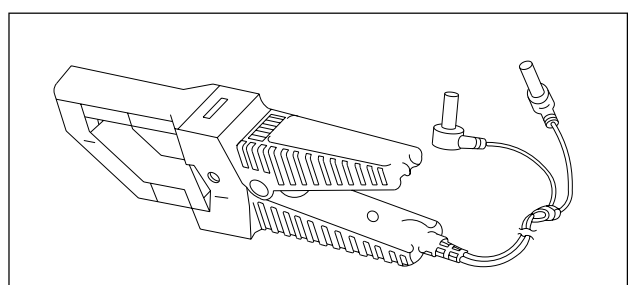

Part No. HD-39617 Inductive Amp Probe. Use with Part No. HD-35500A.

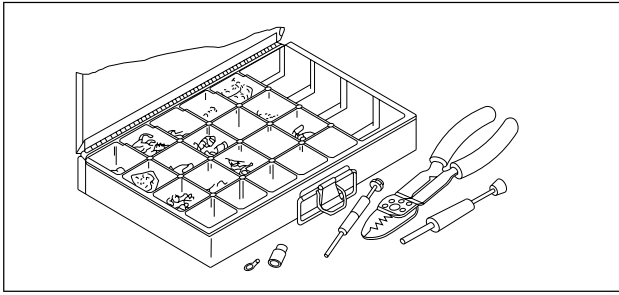

Part No. HD-39621 Electrical Terminal Repair Kit

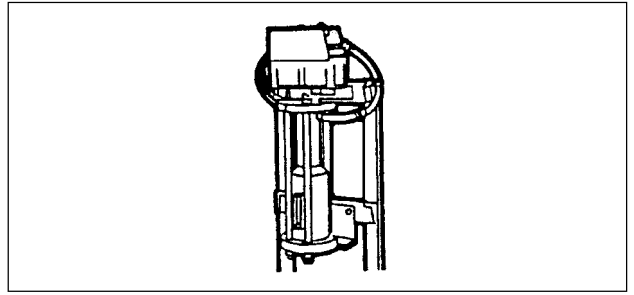

Part No. HD-39823 Oil Filter Crusher, Large

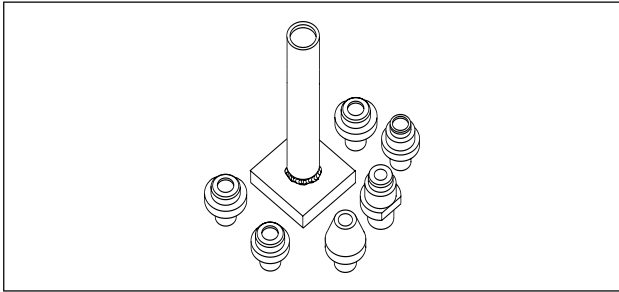

Part No. HD-39782 Cylinder Head Support

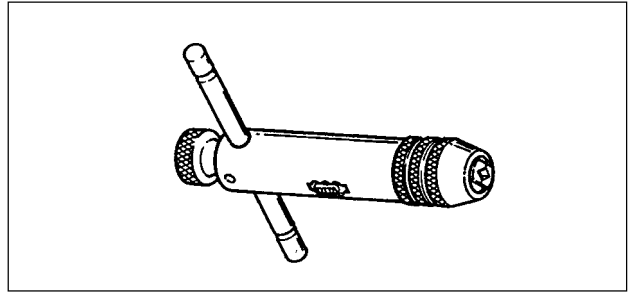

Part No. HD-39847 Universal Ratcheting Tap/
Reamer Handle

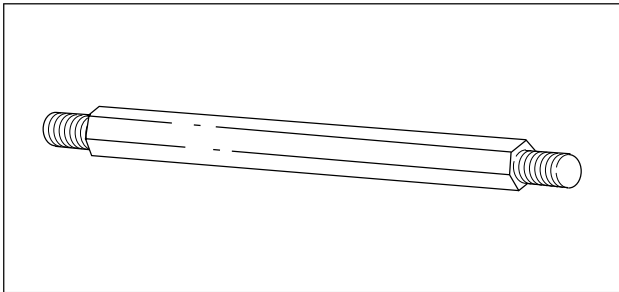

Part No. HD-39786 Cylinder Head Holding Fixture

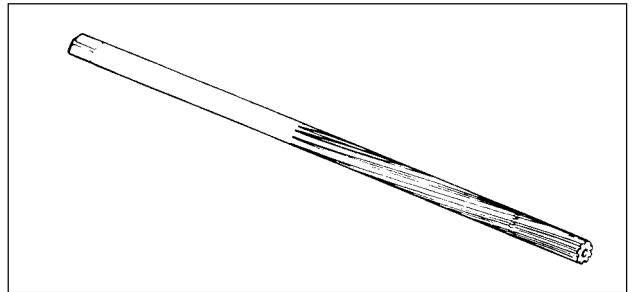

Part No. HD-39932 (Steel) or HD-39932-CAR (Carbide)
Intake and Exhaust Valve Guide Reamer.

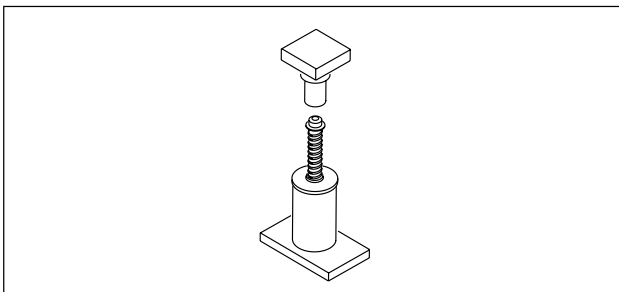

Part No. HD-39800 Oil Filter Crusher, Small

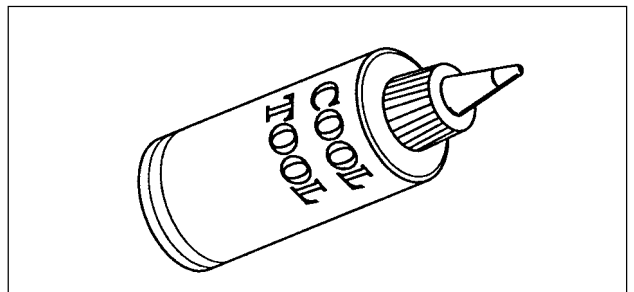

Part No. HD-39964 Reamer Lubricant (Cool Tool)

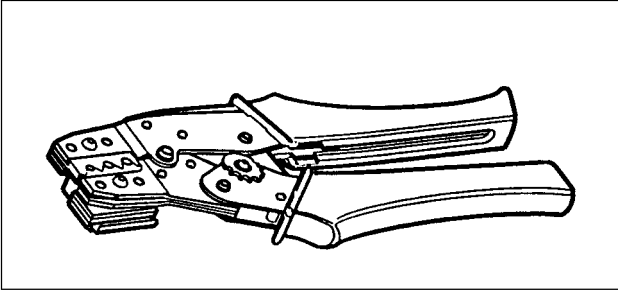

Part No. HD-39965 Deutsch Terminal Crimp Tool

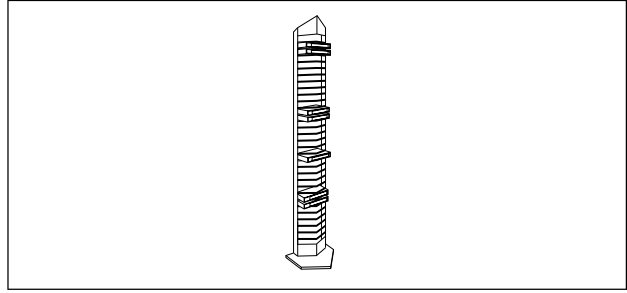

Part No. HD-41155 VHS Video Shelf

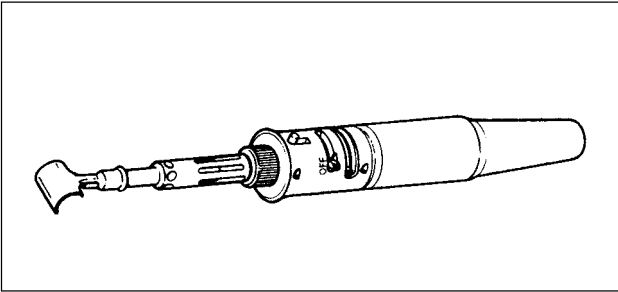

Part No. HD-39969 Ultra-Torch UT-100

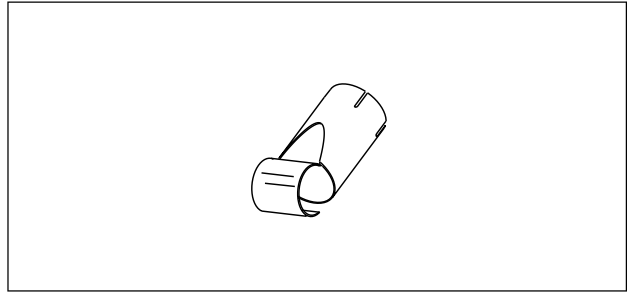

Part No. HD-41183 Heat Shield Attachment.
Use with Part No. HD-25070.

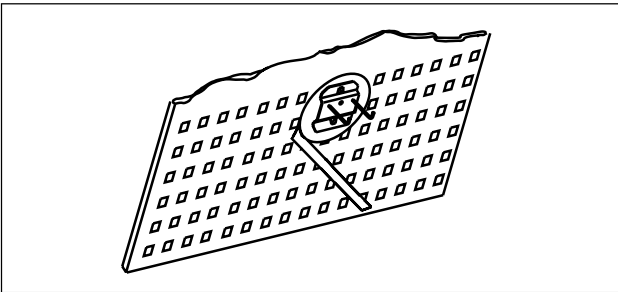

Part No. BU-44473 Tool Organizational System

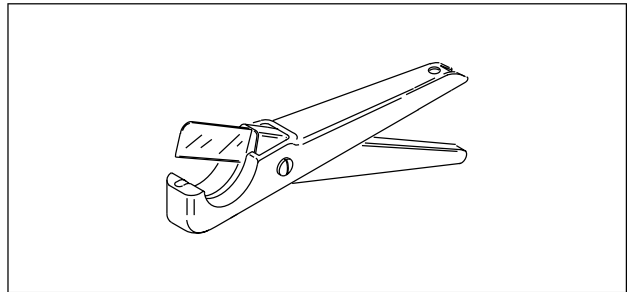

Part No. HD-41185 Hose Cutting Tool

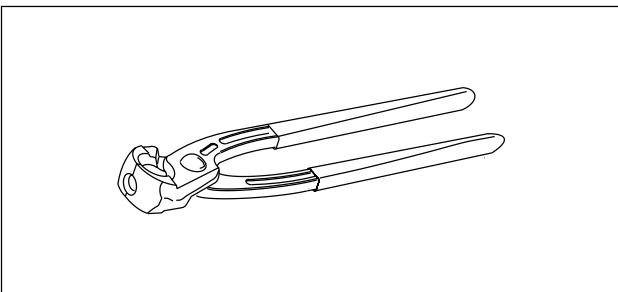

Part No. HD-41137 Hose Clamp Pliers

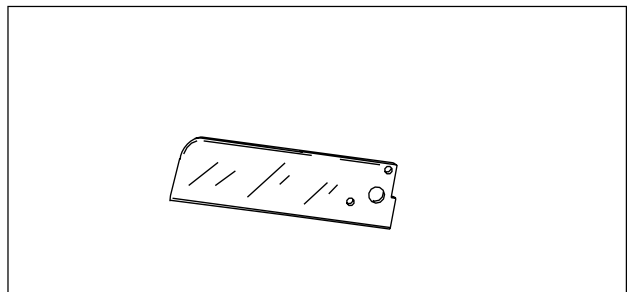

Part No. HD-41185-1 Oil Hose Cutter-Replacement Blade

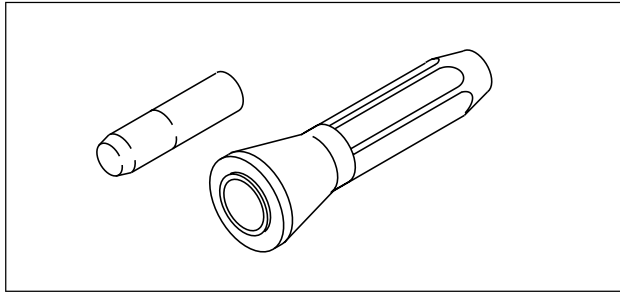

Part No. HD-41405 Main Drive Gear Seal Installer

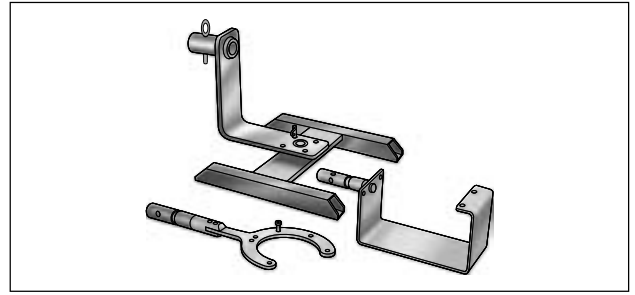

Part No. HD-42310 Engine/Transmission Stand

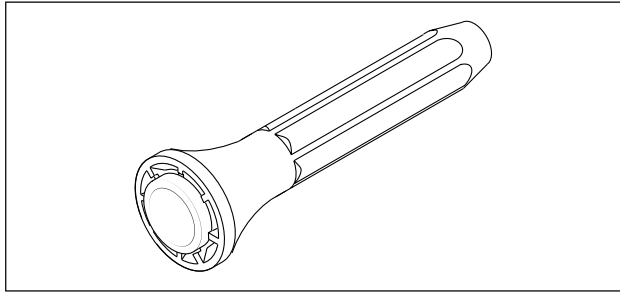

Part No. HD-41496 Main Drive Gear Seal Installer

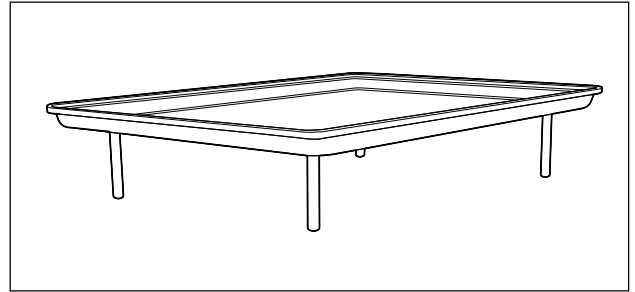

Part No. HD-42310-150 Drip Tray.
Use with Part No. HD-42310.

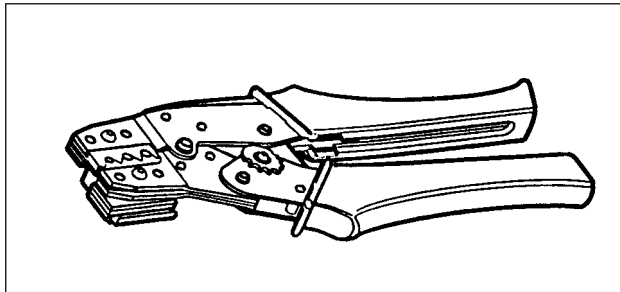

Part No. HD-41609 Amp Terminal Crimp Tool

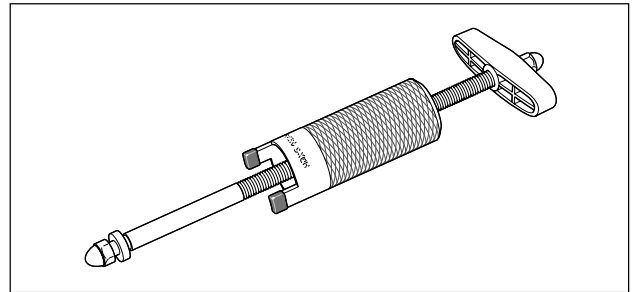

Part No. HD-42320 Piston Pin Remover/Installer

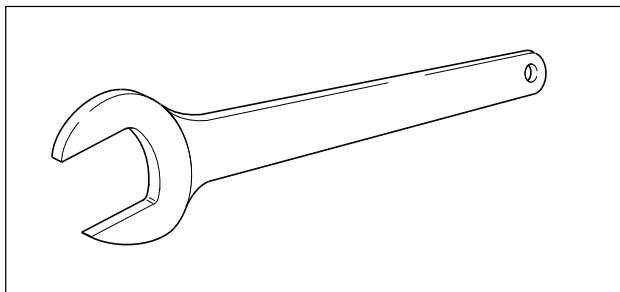

Part No. HD-41675 Oil Pressure Sending Unit Wrench

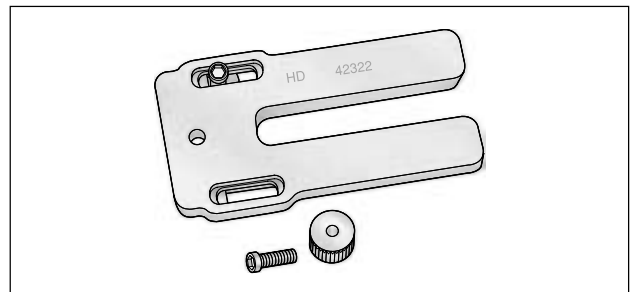

Part No. HD-42322 Piston Support Plate

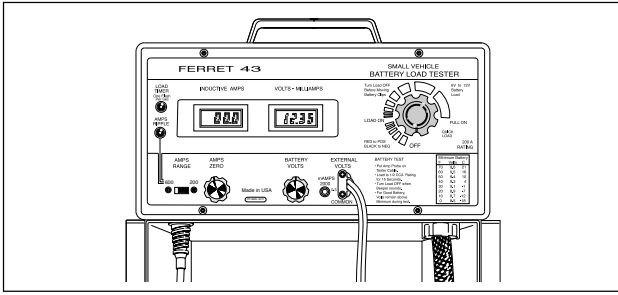

Part No. HD-42376 Battery/Charging System Load Tester

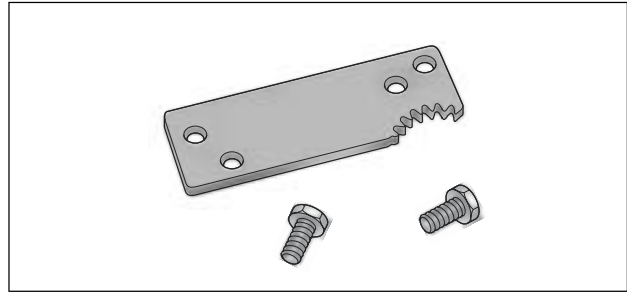

Part No. HD-43984 Crankshaft Locking Tool

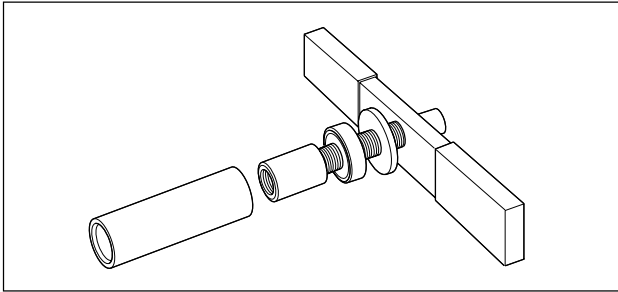

Part No. HD-42579 Sprocket Bearing/Seal Installer

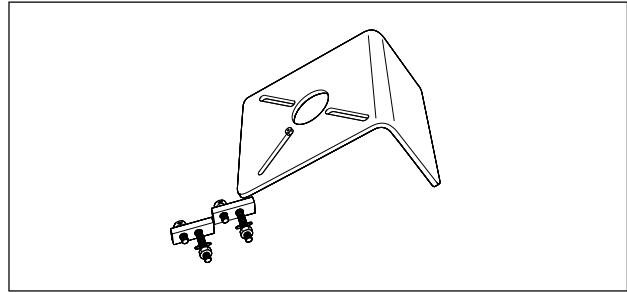

Part No. HD-44358 Flywheel Support Fixture

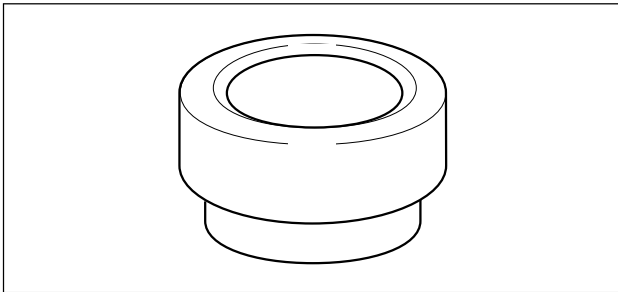

Part No. HD-42774 Sprocket Shaft Seal Installer

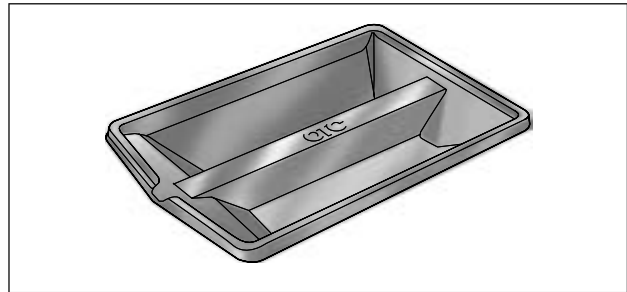

Part No. HD-43682-10 Drip pan.
Use with Part No. HD-43682 or Part No. HD-43646.

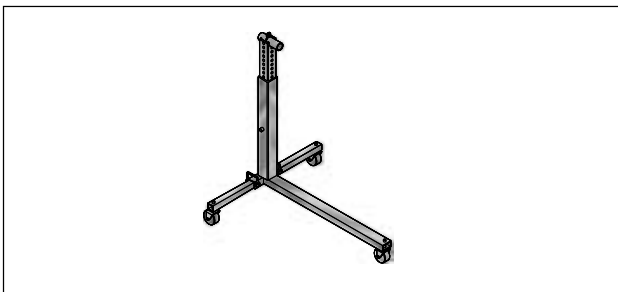

Part No. HD-43646 Engine Stand

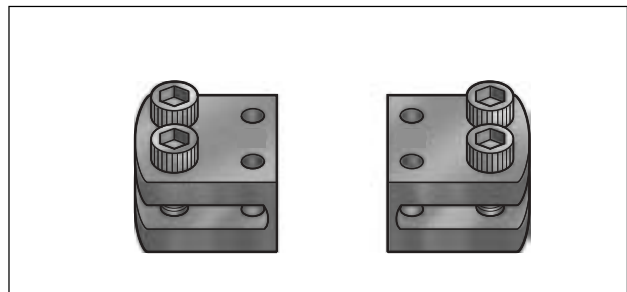

Part No. HD-44069 Timkin Snap ring remover and installer. Use with Part No. HD-44404.

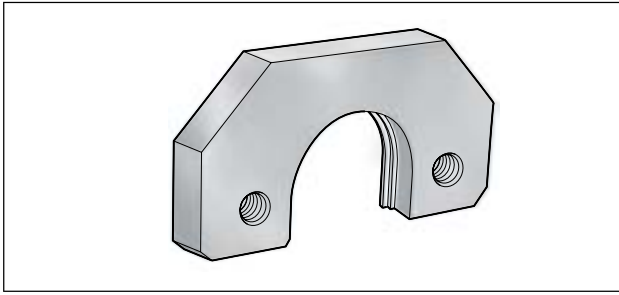

Part No. HD-44404 Timkin Bearing Remover. Use with Part No. HD-44069.

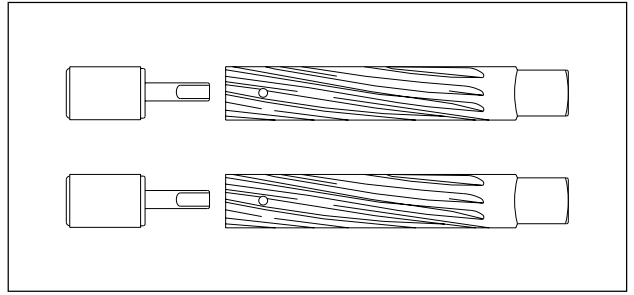

Part No. HD-94800-26A Connecting Rod Bushing Reamers and Pilots

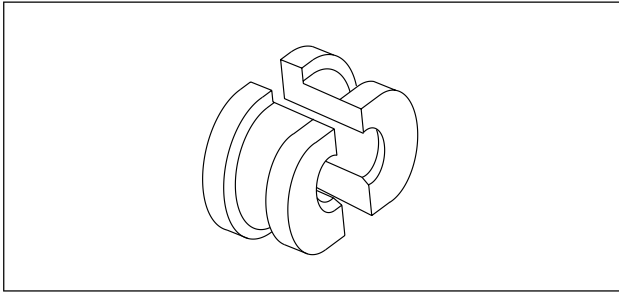

Part No. HD-94547-101 Crankshaft Bearing Outer Race Remover. Use with Part No. HD-94547-102.

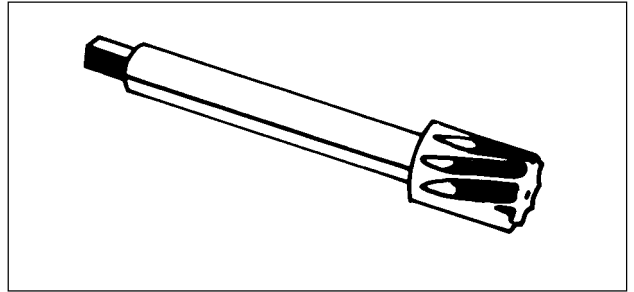

Part No. HD-94803-67 Intake Camshaft Bushing Reamer

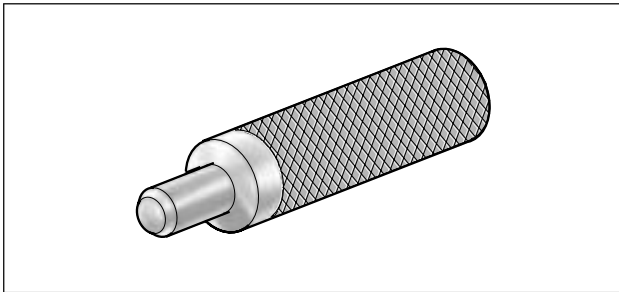

Part No. HD-94547-102 Drive Handle. Use with Part No. HD-94547-101.

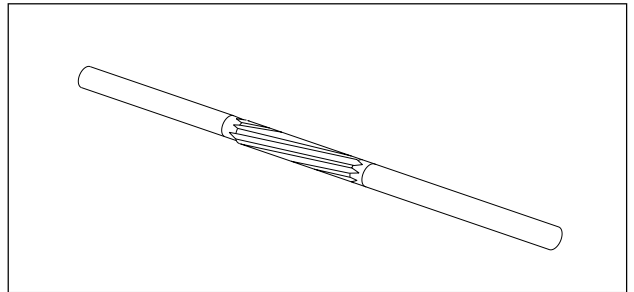

Part No. HD-94804-57 Rocker Arm Bushing Reamer

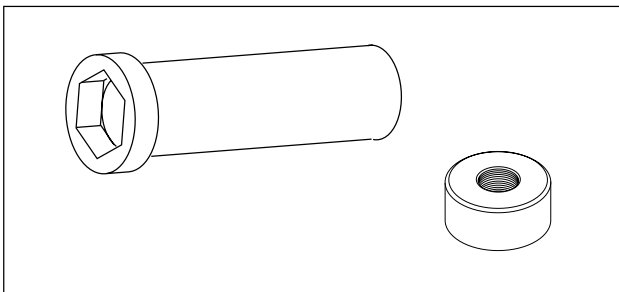

Part No. HD-94660-37B Mainshaft Locknut Wrench Use with Part No. B-43982.

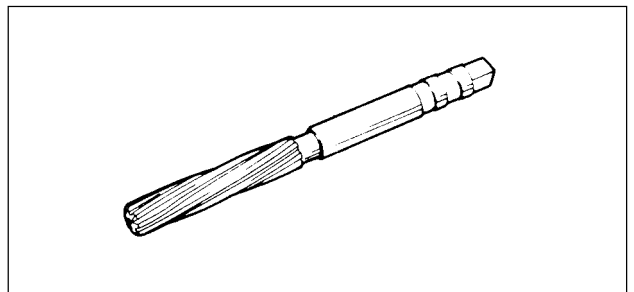

Part No. HD-94812-1 Pinion Shaft Bushing Reamer. Use with Part No. HD-94812-87.

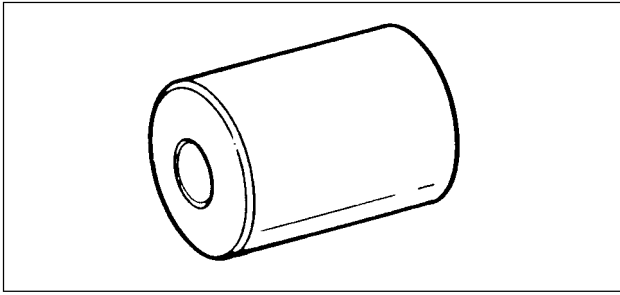

Part No. HD-94812-87 Pinion Shaft Reamer Pilot.
Use with Part No. HD-94812-1.

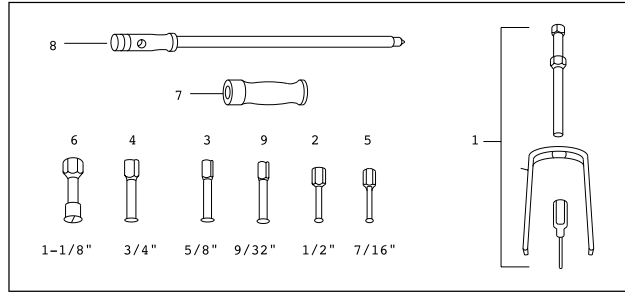

Part No. HD-95760-69A Bushing/Bearing Puller Tool Set
Set includes items 1-7. Items 8 (HD-95769-69), 9 (HD-95770-69) and 10 (HD-95771-69) are optional.

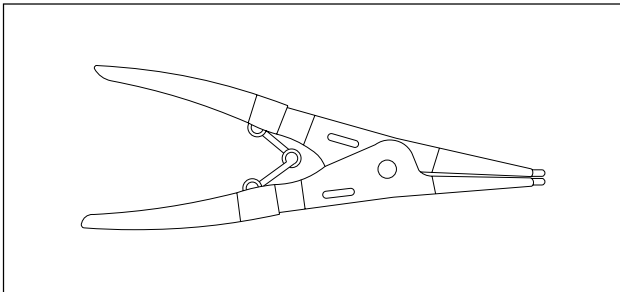

Part No. HD-95017-61 Large External Retaining Ring Pliers

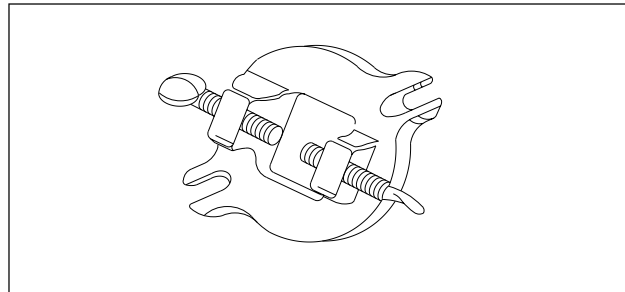

Part No. HD-95952-33B Connecting Rod Clamping Tool

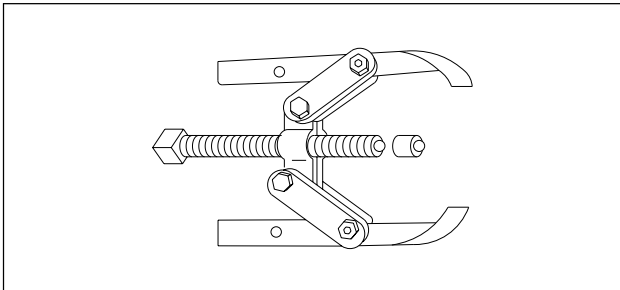

Part No. HD-95635-46 All-Purpose Claw Puller

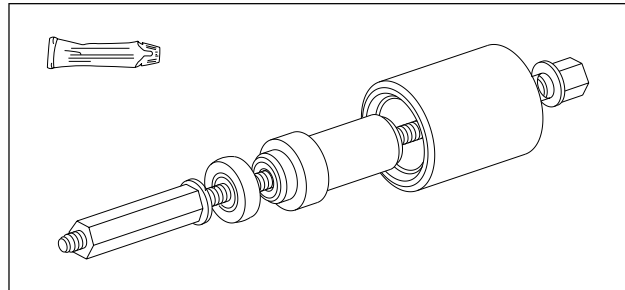

Part No. HD-95970-32D Piston Pin Bushing Tool

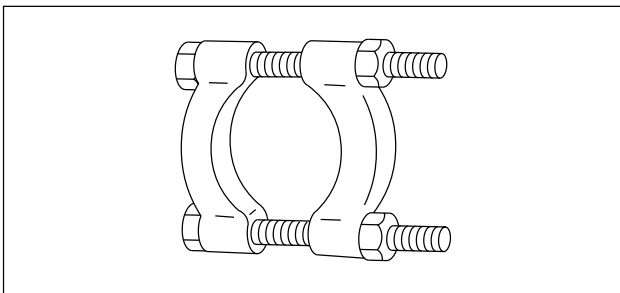
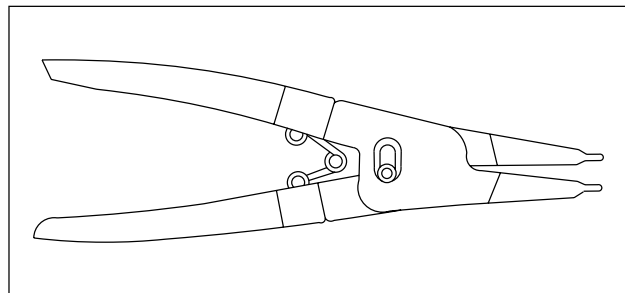
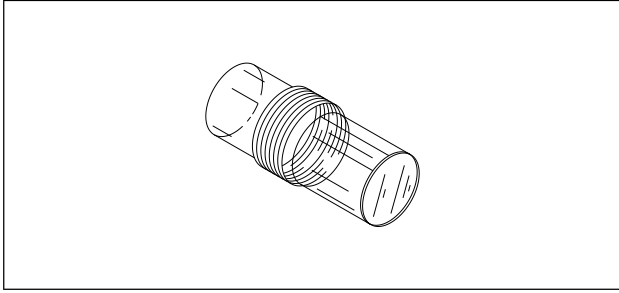

Figure 3-1. Part No. HD-95637-46A Wedge Attachment for Claw Puller. Use with Part No. HD-95635-46.



Part No. HD-96215-49 Small Internal Retaining Ring Pliers



**Part No. HD-96295-65D Timing Mark View Plug.
Use with Part No. HD-33813.**

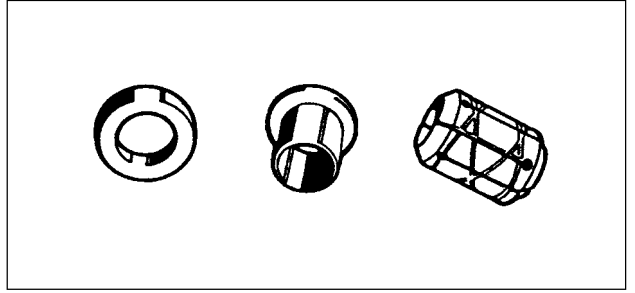

**Part No. HD-96718-87 Pinion Bearing Outer Race
Lapping Kit**

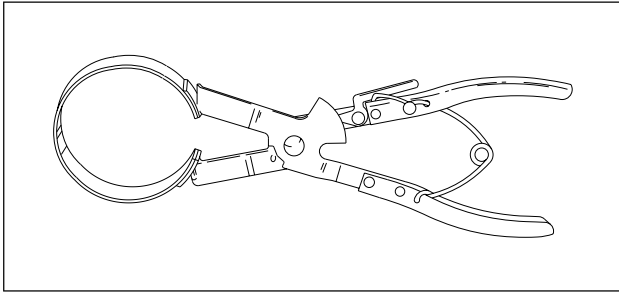

Part No. HD-96333-51C Piston Ring Compressor

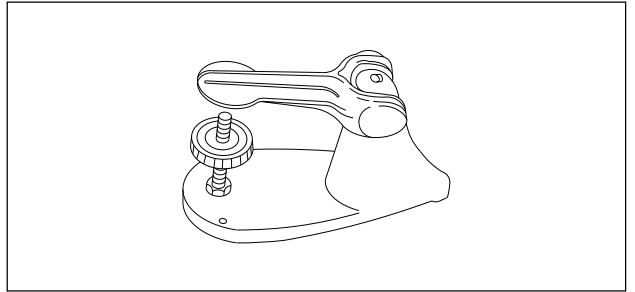

Part No. HD-96796-47 Valve Spring Tester

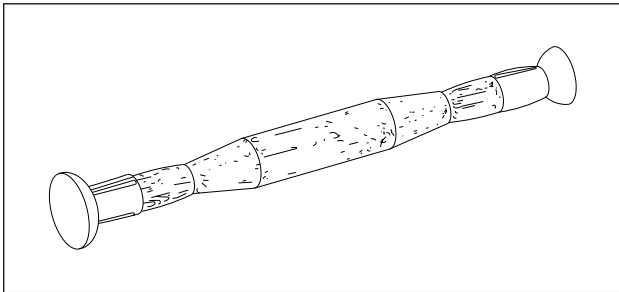

Part No. HD-96550-36A Valve Lapping Tool

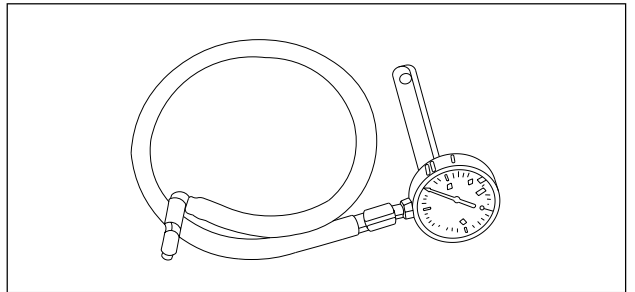

Part No. HD-96921-52B Oil Pressure Gauge

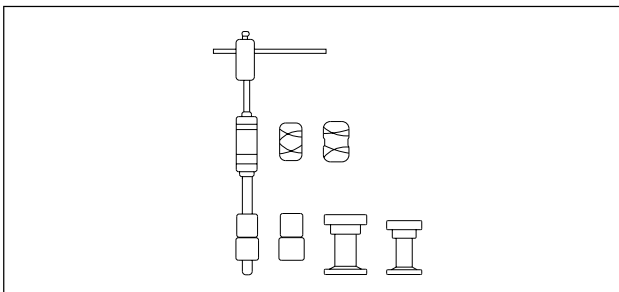

**Part No. HD-96710-40B Crankcase Main Bearing
Lapping Tool**

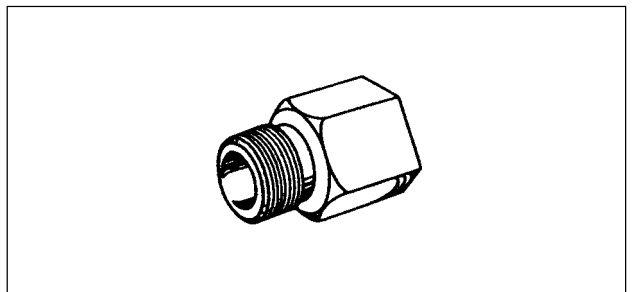

**Part No. HD-96921-58 Oil Pressure Gauge Adapter.
Use with Part No. HD-96921-52B.**

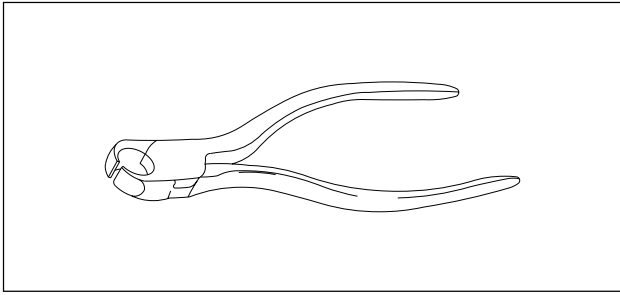

Part No. HD-97087-65B Hose Clamp Pliers

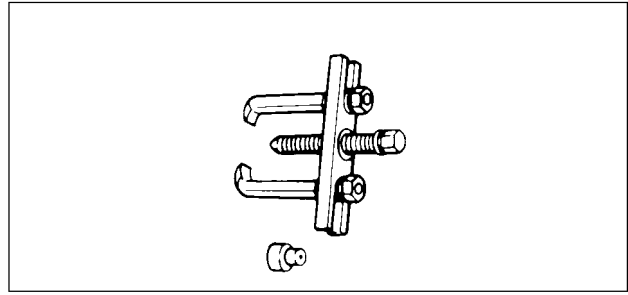

Part No. HD-97292-61 Two Claw Puller

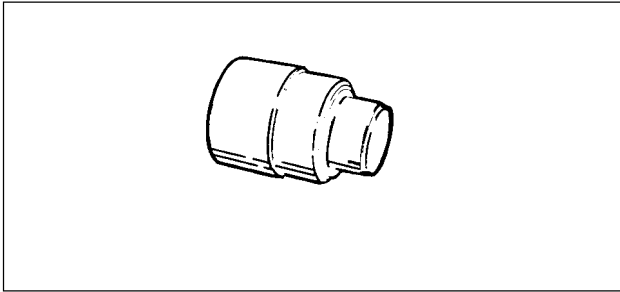

Part No. HD-97273-60 Camshaft Bushing Installer

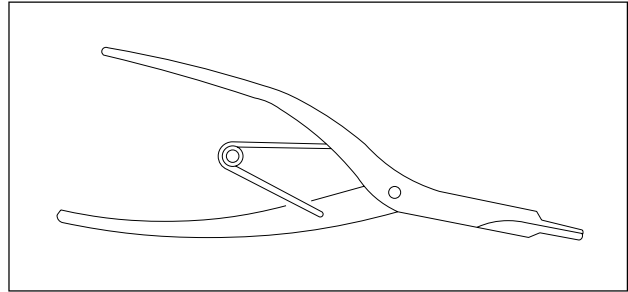

Part No. J-5586 Transmission Shaft Retaining Ring Pliers

